

Whilst every attempt has been made to ensure the accuracy of the floorplan, measurements of doors, windows and rooms are approximate. These plans are for representation purposes only as defined by RICS Code of Measuring Practice and used as such by any prospective purchaser. (ID939231)

PRODUCED FOR BORLAND & BORLAND ESTATE AGENTS

Ground Floor

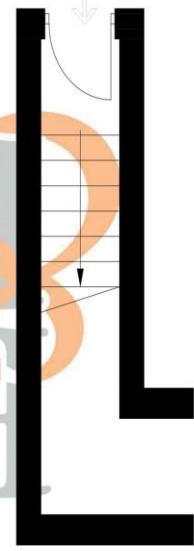

First Floor



Flat 5, 42a, North Street, PO10 7DJ
Approximate Gross Internal Area = 51.1 sq m / 550 sq ft



Directions
SAT NAV: PO10 7DJ

LEASE DETAILS

- Full 999-year lease
- Flats share ownership of leasehold and freehold
- No ground rent
- £1000 pa Service charge

We Understand from our seller:





Offered with no forward chain, purpose built first floor apartment located within quarter of a mile of Emsworth town square.

Accommodation comprises of: Private entrance with stairs to first floor. Landing. Sitting/ Dining Room. Kitchen. Master double Bedroom. Shower Room. This property benefits from gas central heating, double glazed windows and an allocated parking space.

Emsworth is situated on the upper reaches of Chichester Harbour, an Area of Outstanding Natural Beauty. Considered one of the best locations of the south coast for sailing and walking. The town of Emsworth has an attractive range of local sights, amenities, sailing clubs, boat yards, restaurants and is within easy travelling distance of the historic City of Chichester. Connects to Mainline railway station to London at nearby Havant.



- FIRST FLOOR APARTMENT
- PRIVATE ENTRANCE
- DOUBLE BEDROOM
- MODERN KITCHEN
- ALLOCATED PARKING SPACE

- DOUBLE GLAZING
- GAS CENTRAL HEATING
- NO FORWARD CHAIN
- SHARE OF FREEHOLD
- CLOSE TO EMSWORTH TOWN CENTRE & RAILWAY STATION